

 *Digger's*
Speed Pin™

Three Pin Packs are Taped Together

To Separate:

Hold as shown below



Push to separate
Pin Pack from front tape



Pull to separate
Pin Pack from back tape

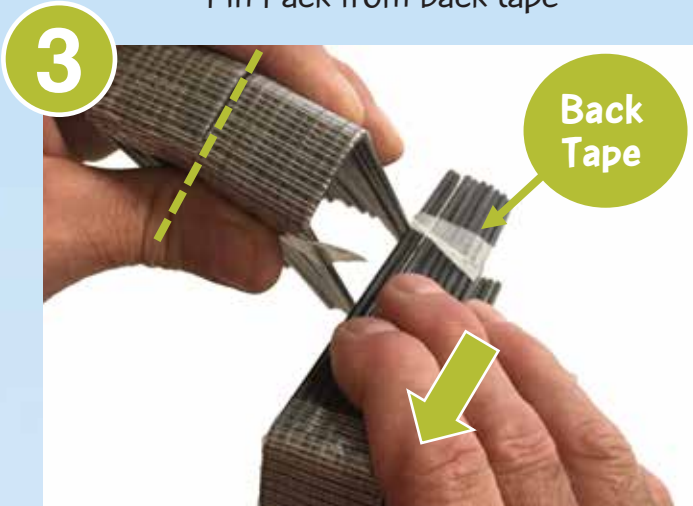

Remove remaining front
and back tape strips



See reverse side for Speed Pin use instructions



Scan the code or visit www.SpeedPinStaples.com for more ideas and information
Email info@SpeedPinStaples.com • PO Box 1551 Soquel, CA 95073
Phone 831-462-6096

 *Digger's*
Speed Pin™

How To Use

1 Finger-Mount Style

Pick Off

Mount the Pin Pack of 10 staples over middle finger, and pick off a Speed Pin. The remaining staples are conveniently held captive and organized.

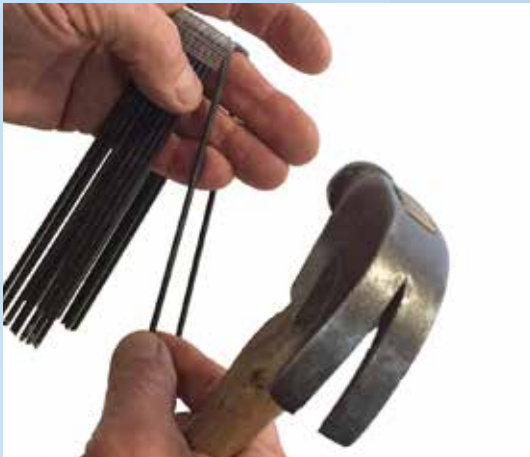

Pound In

Transfer staple to opposite hand, as shown, and pound in.



2 Can-Pick Style (Use Carry Can holster, available for purchase separately)

Place Pin Pack(s) into the Carry Can. Grasp one Pin Pack and pick off two Speed Pins.



Remove the crown tape from the Pin Pack to release the remaining Speed Pins. The Speed Pins are ready to pick, one-by-one, from the Carry Can.



Scan the code or visit www.SpeedPinStaples.com for more ideas and information

Email info@SpeedPinStaples.com • PO Box 1551 Soquel, CA 95073

Phone 831-462-6096